

Rotary Solenoid

--M310



Description

The high-performance **rotary solenoid** designed for a wide range of applications. With its **compact size** (outer diameter 28mm, thickness 16mm), this powerful solenoid is perfect for systems where space is limited but precision is critical. Equipped with a **spring self-reset mechanism**, the solenoid ensures smooth, reliable operation with optional angles of **25°**, **35°**, or **45°**, allowing for flexible integration into diverse systems. Its **long lifespan**, exceeding **2 million cycles**, guarantees consistent performance over time, minimizing the need for maintenance and ensuring durability in high-demand environments. Ideal for **laser equipment shutters** and **medical detection shutters**, this rotary solenoid is engineered to meet the exacting standards of industries requiring precision and reliability. Whether you're working with optical systems or medical diagnostic tools, this solenoid offers the ideal solution for fast, efficient movement and secure positioning.

Specifications

Duty Circle		100% continues	75% Or less	50% Or less	25% Or less	10% Or less
Max Time (s)		∞	105	100	36	7
Watts (20°C)		7	9.3	14	28	70
Ampere-turns (20°C)		425	490	602	849	1350
Torque (N.m 20°C)	25°	0.022	0.035	0.046	0.069	0.15
	35°	0.017	0.022	0.035	0.058	0.127
	45°	0.012	0.014	0.021	0.035	0.081
Resistance ± 10% (20°C)		Voltage DC (V)				
1.96		3.5	4.1	5	7.1	11
3.16		4.5	5.1	6.3	8.9	14
5.1		5.6	6.5	8	11	18
6.94		7.1	8.1	10	14	22
11		8.9	10	13	18	28
16.9		11	12	16	22	36
28.3		14	16	20	28	45
42.8		18	20	25	35	56
69.6		22	26	32	45	71
112		28	32	39	56	89
148		35	41	50	71	112
221		45	51	63	89	142
352		56	65	80	112	178
568		71	81	100	141	224
882		89	102	126	178	283

Note: There is 1mm axial displacement during operation, and 35° limit are common options.

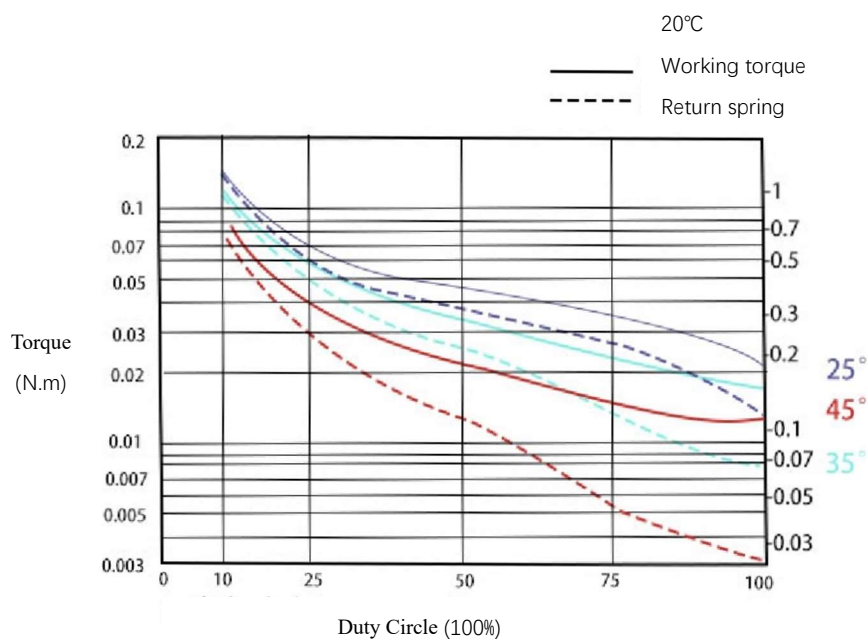

Dimension

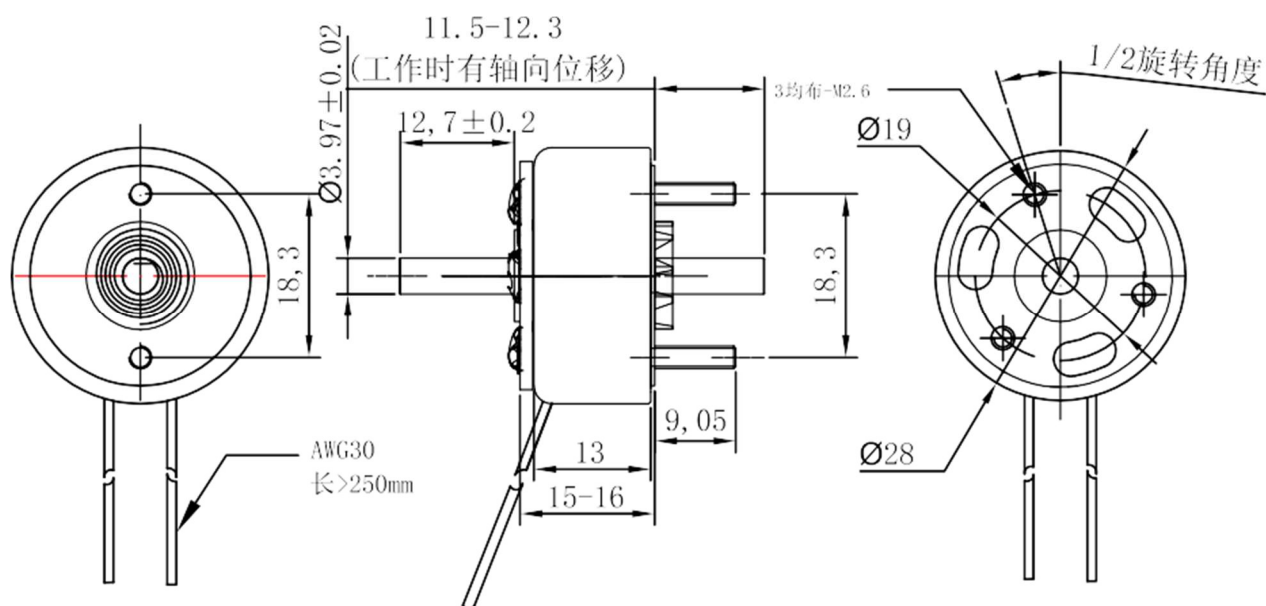

Mounting screw length: 9mm by default, customizable

Unit: mm

Limit Options

Optional angles:

25°: left/right

35°: left/right

45°: left/right



Right rotation



Left rotation

Shaft Options

Default: Top and Bottom output shaft

H: Top output shaft

L: Bottom output shaft

2P: no output shaft



Top Output



Top and Bottom output shaft



Bottom Output

Support

Email: sales@fandei.com

T/WhatsApp: +8615902990387

W: www.shanglinmotor.com